

Arlo LED Table and Desk Lamps

Model: **TLED36 & FLED36**

Instruction and assembly Information



With care and attention to the following information your Arlo lamp will give you years of satisfactory service.

IMPORTANT PLEASE READ:

- Unpack the lamp and the power supply cord
- Choose a suitable position for the Lamp- this lamp is to be used on a flat level surface
- This product is not a toy – DO NOT cover the lamp or place against flammable materials
- If power supply adapter is damaged ensure it is replaced
- The Desk / Floor Lamp is not waterproof – DO NOT use outdoors or in wet areas.

Assembly for Arlo Table Lamp TLED36:

When assembling the stem to the base ensure it is exactly 90 degrees to the base before turning the stem and base together. If jamming occurs unwind and re-start at 90 degrees. Tighten the stem to the base firmly.

Join the co-axial connectors together from the table lamp and power supply pack before you plug it into the wall socket.

Assembly for Arlo Floor Lamp FLED36:

Assemble threaded joins as per diagram step 1, then step 2. When stems are aligned correctly the threads will wind together easily. If jamming occurs unwind and re-start. Attach the lower stem to the base using the bolt and allen key provided, tighten firmly. Join the co-axial connectors together from the floor lamp and power supply pack before you plug it into the wall socket.

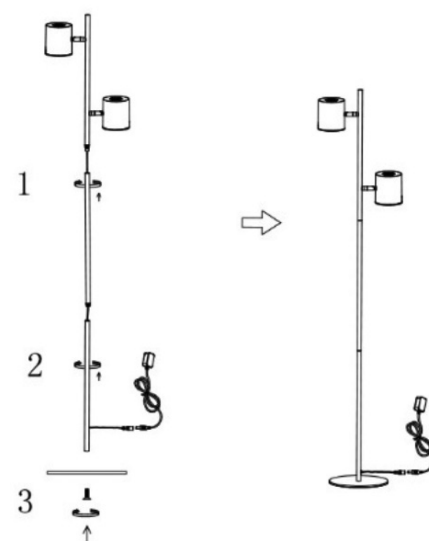

Lamp Operation – On/Off & dimming

- Switch on the light by touching the “touch switch”  located on the silver edge on the head of the lamp

First touch = 10% light level

Second touch = 45% level

Third touch = 100% light level

Forth touch = Light turns off

Technical:

TLED36

- Power pack Input 230V-240V 50Hz
- Power pack Output 12V 400mA
- LED Lamp power 5Watt

FLED36

- Power pack Input 230V-240V 50Hz
- Power pack Output 13V 900mA
- LED Lamp power 2 x 5Watt

Important:

- Only use the Lamp with the “Plug-in power pack and Cord” supplied
- Do not modify the Lamp
- Do not dismantle or touch the LED lamp
- Clean the Lamp with a dry cloth
- If Touch switch is inactive, turn off the power supply at wall, wait 10 seconds and turn on
- The manufacturer will not be responsible for any damage caused by misuse or modification of this product.

Keep these instructions for future reference